



## REHAU TOTAL70s WINDOW AND DOOR SYSTEM

### SCULPTURED PROFILE PRINT

# REHAU TOTAL70s

## PROFILE PRINT

---

The following profile print shows PVC-U main profiles, glazing beads and steel reinforcement profiles dedicated to the REHAU TOTAL70<sub>MF</sub> Window and Door system.

Each item is identified by at least one Article No., many have two Article No's. The first Article No. identifies the basic item, the second identifies the laminated item.

A 3 digit Variant No. after the Article No. then denotes standard packaging and colour options:

### Key to variant system.

701	Individual packs	White profile/beads with Black co-ex gasket
705	Individual packs	White profile/beads with White co-ex gasket
901	Stillage	White profile
751	Individual packs	Mahogany foil both faces on Brown base profile/beads with Black co-ex gasket
721	Individual packs	Mahogany foil to Face A on White base profile
251	Individual packs	Rosewood foil both faces on Brown base profile/beads with Black co-ex gasket
221	Individual packs	Rosewood foil to Face A on White base profile
351	Individual packs	Golden Oak foil on both faces on Acorn base
321	Individual packs	Golden Oak foil to Face A on a White base profile
Other Variants	Various items	Other variants do not necessarily follow a set pattern. See relevant section of this profile print for exact description

Where profiles are symmetrical there is no need to distinguish between faces, therefore only variant 721, 221 or 321 is needed. Please refer to ordering guide for standard lengths, pack quantities and confirmation of Article Nos & Variant Nos together with standard/non standard status.

**\* DENOTES AVAILABLE AS A SPECIAL ORDER - NOT A STANDARD STOCK ITEM - PLEASE REFER TO SALES OFFICES FOR MINIMUM QUANTITIES, LEAD TIMES AND PRICES.**

---

# REHAU TOTAL70s

## OUTER FRAMES

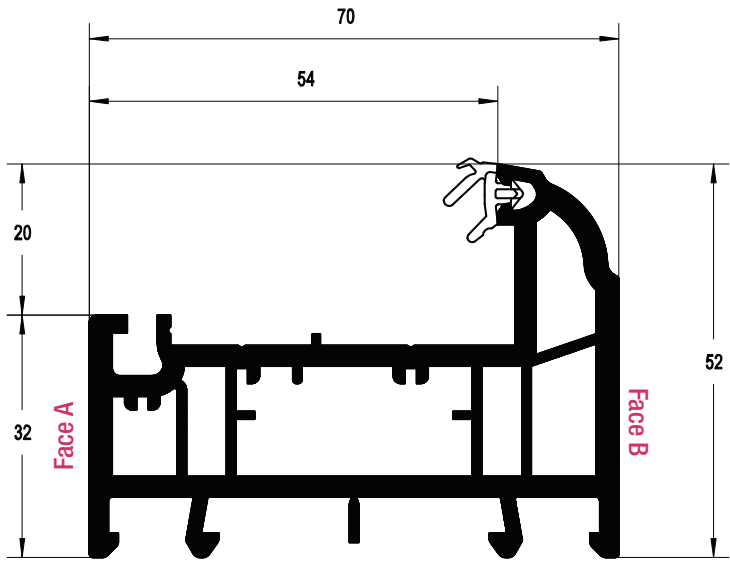

Casement Slim Outer Frame 52mm (5 Chamber)  
 White Profile Art. No. 546415  
 Laminated Profile Art. No. 586415

	216391	318555
	1.5mm	1mm
lx	0.61	0.13
ly	0.17	0.46

216391 - 25 x 11  
 318555 - 25 x 11

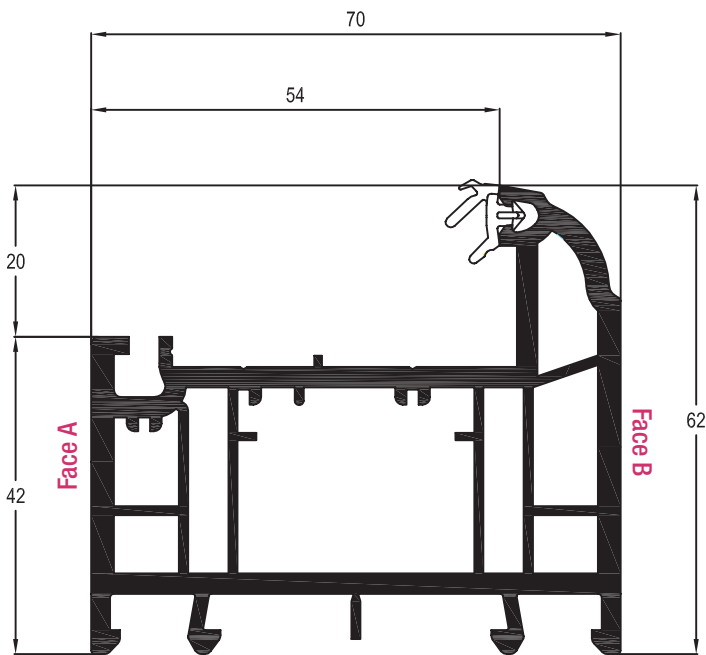
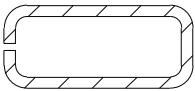

Casement Intermediate Outer Frame 62mm (5 Chamber)  
 White Profile Art. No. 546425  
 Laminated Profile Art. No. 586425

	216392	318565
	1.5mm	1mm
lx	1.03	0.58
ly	0.80	0.75

216392 - 25 x 21  
 318565 - 25 x 21

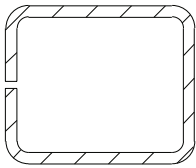

# REHAU TOTAL70s

## OUTER FRAMES

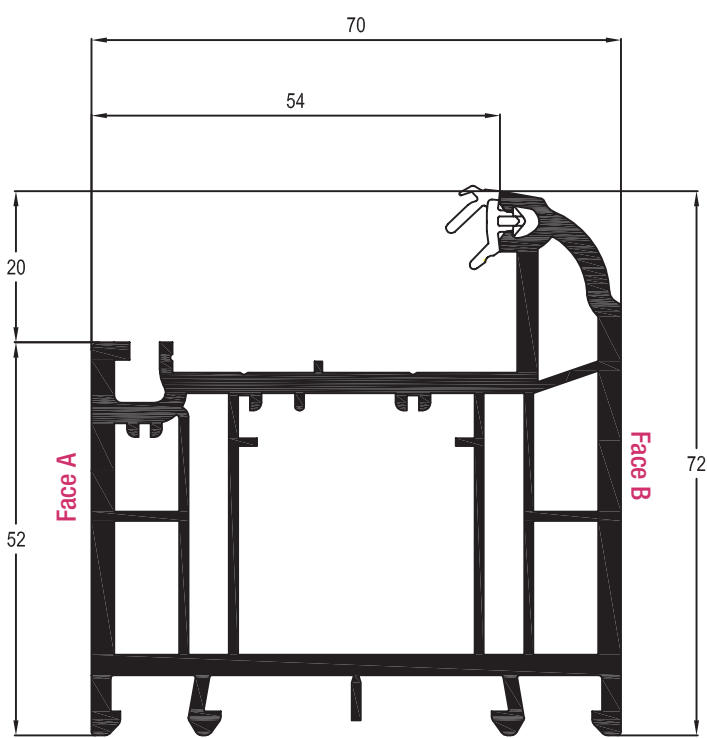

Casement Universal Outer Frame 72mm (5 Chamber)  
 White Profile Art. No. 546435  
 Laminated Profile Art. No. 586435

	216393	318575
	1.5mm	1mm
lx	1.44	1.45
ly	2.0	1.03

216393 - 25 x 31  
 318575 - 25 x 31

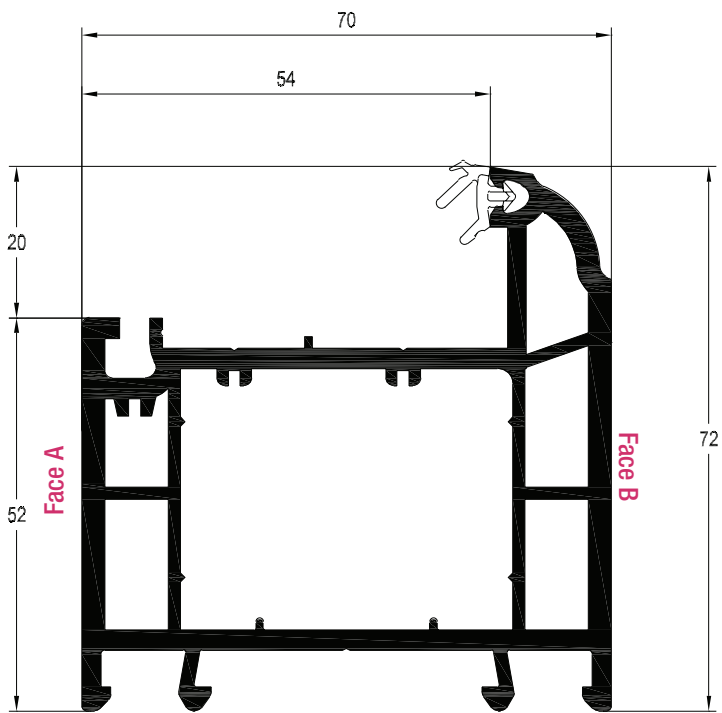
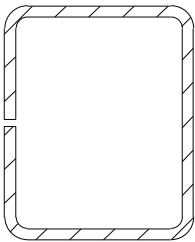

Casement Universal Outer Frame 72mm  
 White Profile Art. No. 546655

	261958	249848	200327
	1.5mm	1mm	1.5mm
lx	4.87	3.45	3.98
ly	2.93	1.75	2.56

261958 - 42 x 30

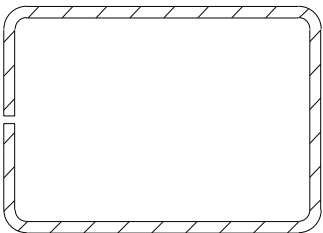

249848 - 42 x 30

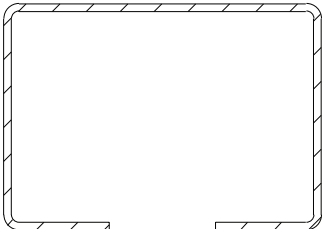

200327 - 42 x 30 x 30 x 18

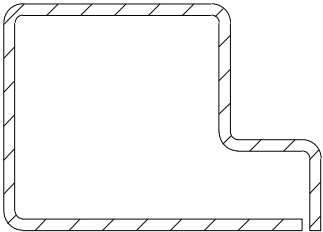

# REHAU TOTAL70s

## CASEMENT SASHES

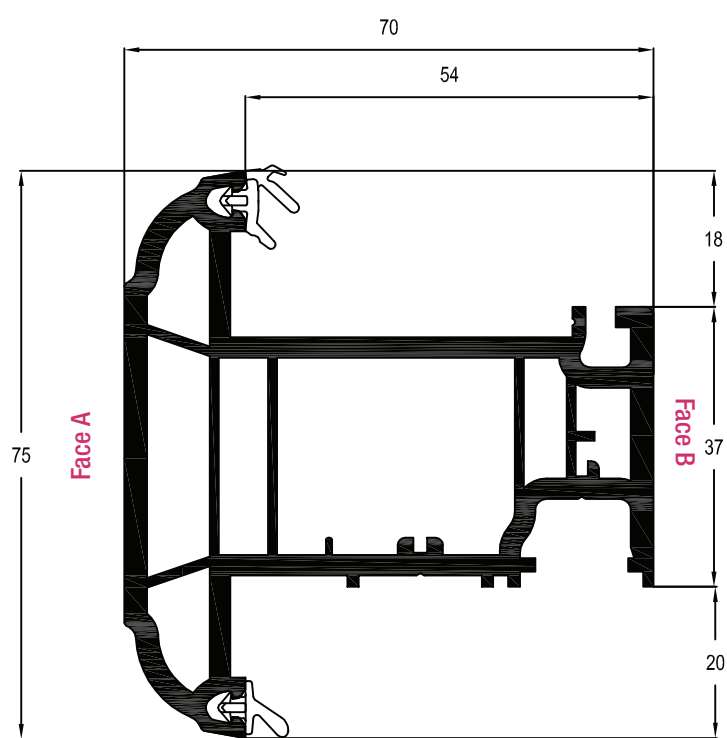

Casement T Sash 75mm (5 Chamber)  
 White Profile Art. No. 546455  
 Laminated Profile Art. No. 586455

	216394	318585
	1.5mm	1mm
lx	1.47	0.79
ly	1.1	1.05

216394 - 30 x 23  
 318585 - 30 x 23

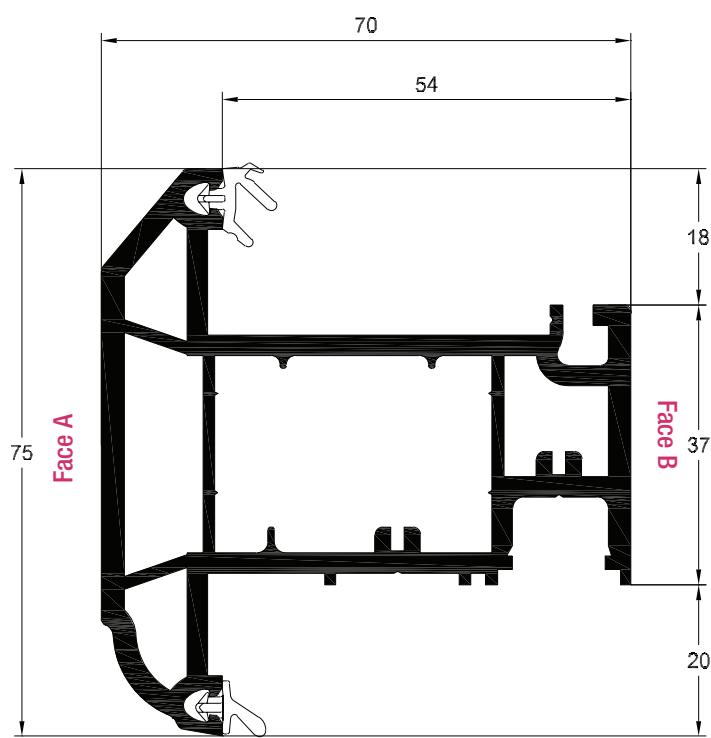
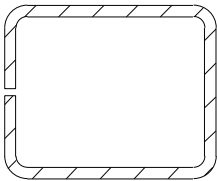

Part Sculptured Casement T Sash 75mm  
 White Profile Art. No. 546586  
 Laminated Profile Art. No. 576267

	261968*	287777
	1mm	1mm
lx	1.91	1.65
ly	0.23	0.58

261968\* - 20 x 35 x 20 x 19

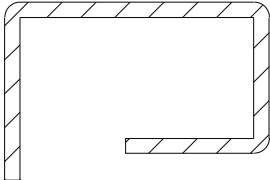

287777 - 35 x 20 x 19

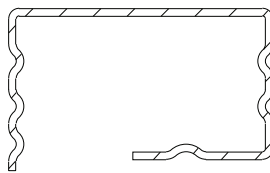

\*Special order (allows for maximum sizes to be achieved)

# REHAU TOTAL70s

## TILT AND TURN SASH

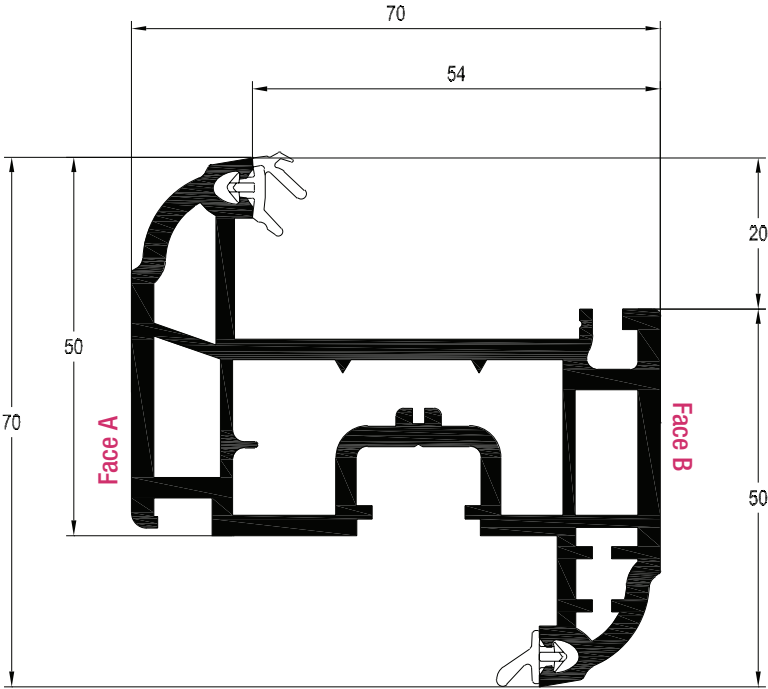

Tilt and Turn Sash 70mm  
 White Profile Art. No. 546695  
 Laminated Profile Art. No. 576695

	287779
	1mm
Ix	1.91
Iy	0.23

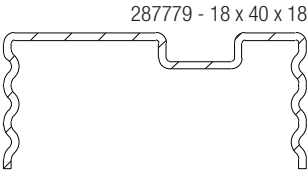

# REHAU TOTAL70s

## DOOR SASHES

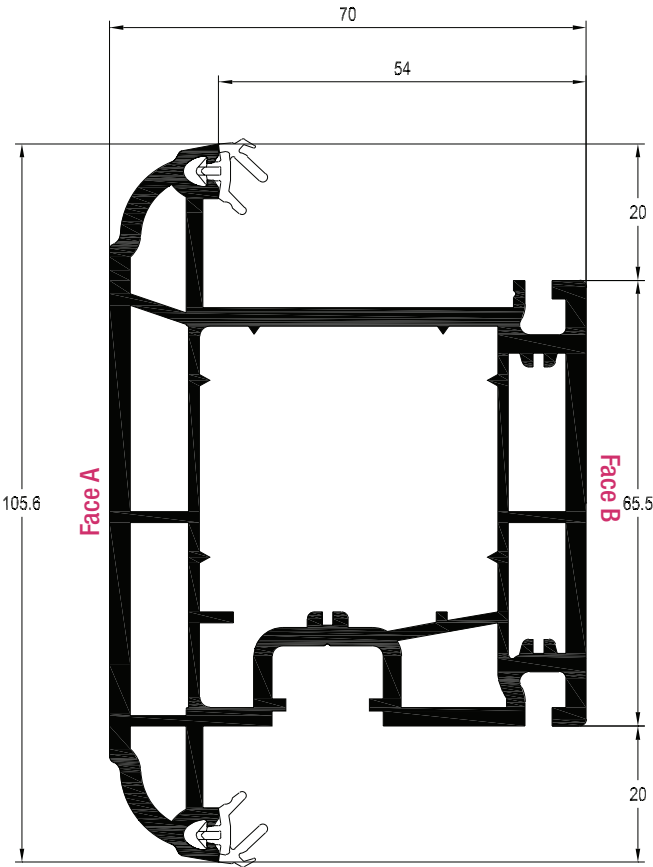

Door T Sash / Midrail 105.5mm  
 White Profile Art. No. 546725  
 Laminated Profile Art. No. 576725

The same steels apply to both the T and Z Door Sashes

	252827	287787	258841	200374
	2mm	1mm	2mm	1.5mm
Ix	6.60	3.75	7.21	5.64
Iy	4.80	2.57	7.21	5.64

252827 - 40 x 40 x 40 x 12  
 Pre-routed 262490 - 40 x 40 x 40 x 12

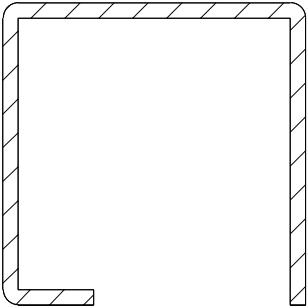

287787 - 40 x 40 x 40 x 12  
 Pre-routed 287789 - 40 x 40 x 40 x 12

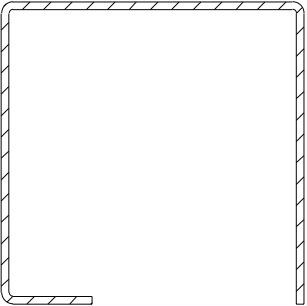

Door Z Sash 105.5mm  
 White Profile Art. No. 546715  
 Laminated Profile Art. No. 576715

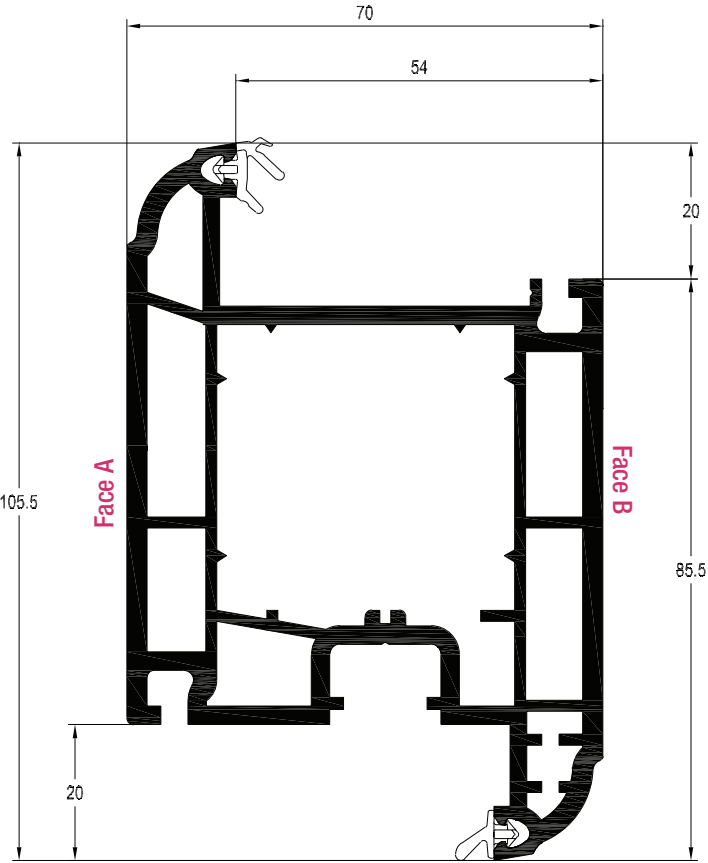
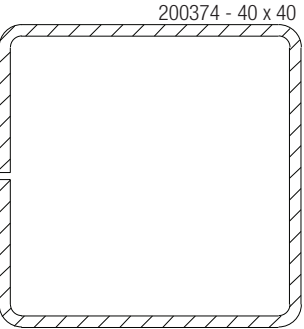
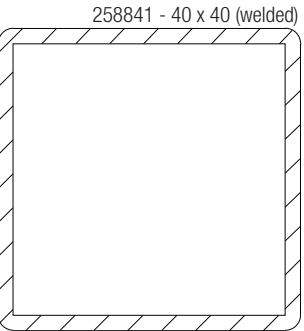

# REHAU TOTAL70s

## TRANSOM / MULLIONS

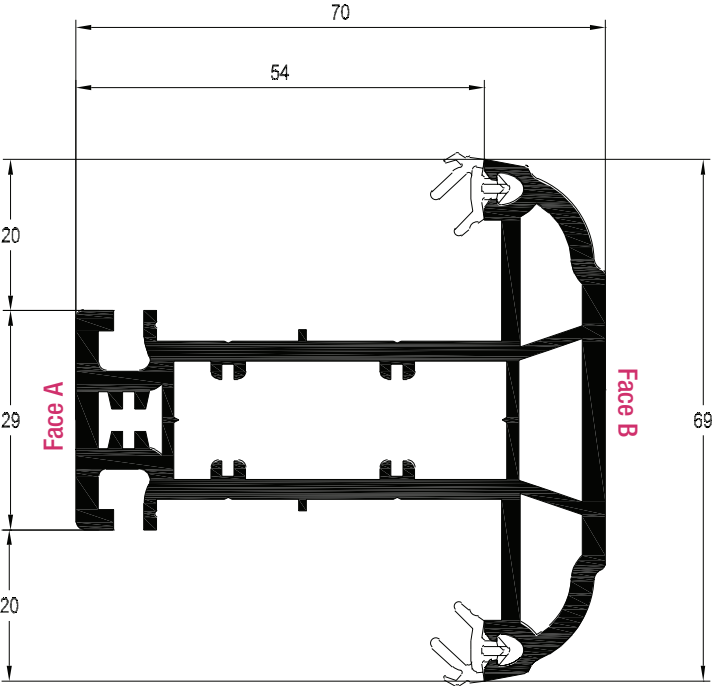

Slim Transom / Mullion T 69mm  
 White Profile Art. No. 546665  
 Laminated Profile Art. No. 576665

	261748	249838	261948
	2mm	1mm	Aluminium
lx	3.06	1.77	4.18
ly	0.27	0.14	0.3

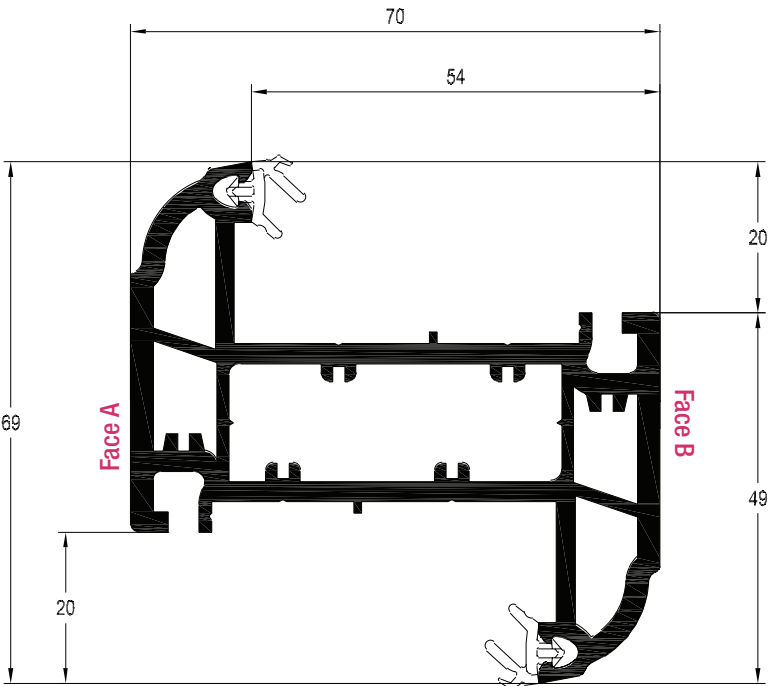
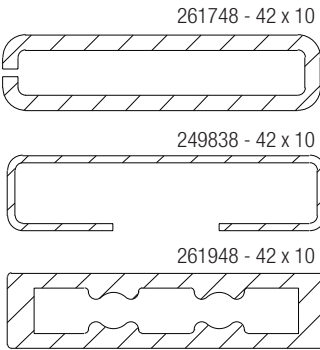

Slim Transom / Mullion Z 69mm  
 White Profile Art. No. 546675  
 Laminated Profile Art. No. 576675

	261748	249838	261948
	2mm	1mm	Aluminium
lx	3.06	1.77	4.18
ly	0.27	0.14	0.3

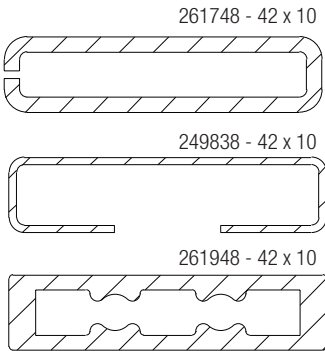



# REHAU TOTAL70s

## TRANSOM / MULLIONS

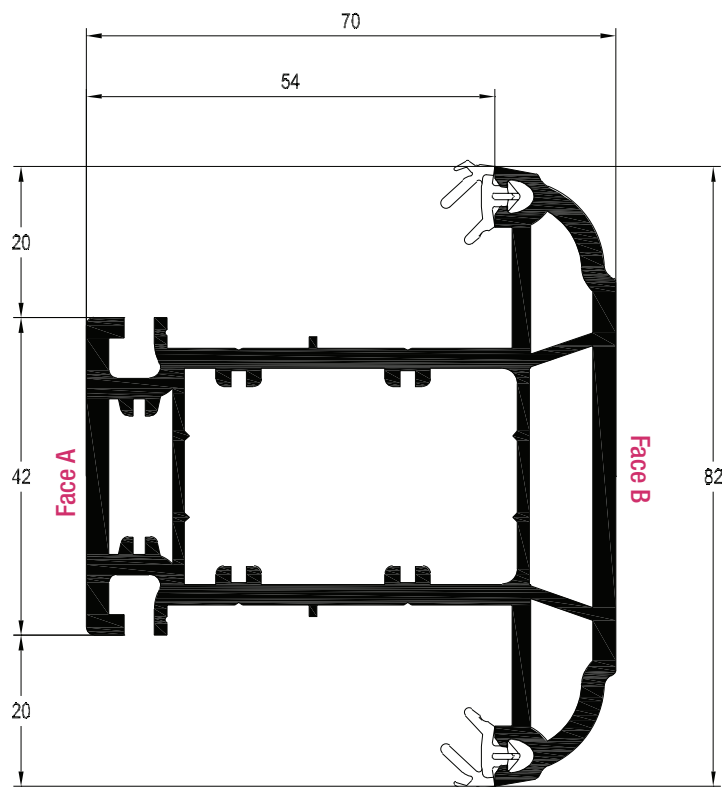

Large Transom / Mullion T 82mm  
 White Profile Art. No. 546745  
 Laminated Profile Art. No. 576745

	261738	287776	200347
	2.5mm	2mm	2.5mm
lx	6.06	5.14	4.70
ly	2.33	2.0	2.11

261738 - 42 x 23

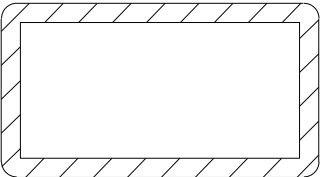

287776 - 42 x 23



200347 - 42 x 30 x 23

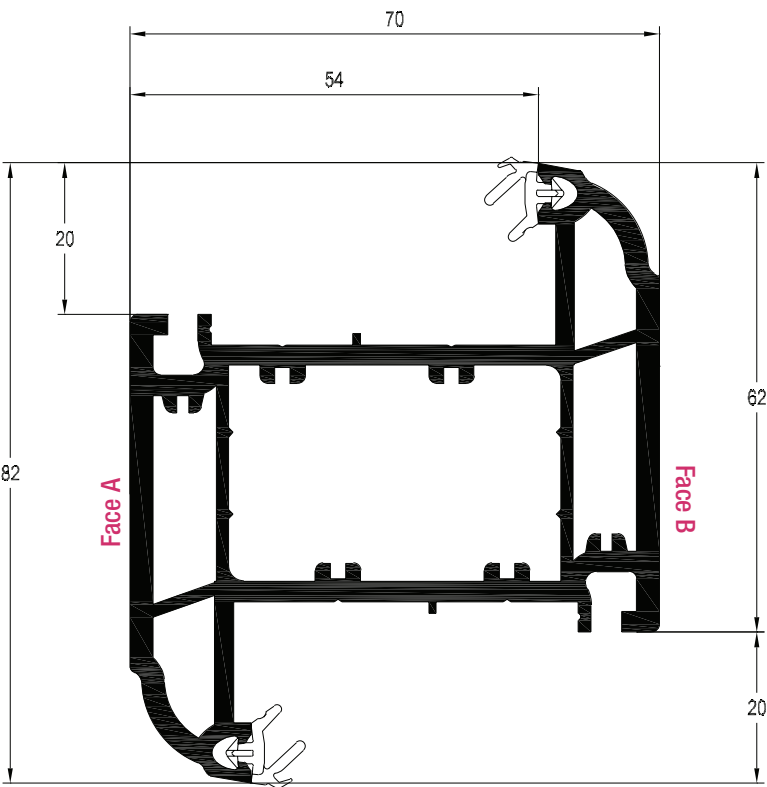
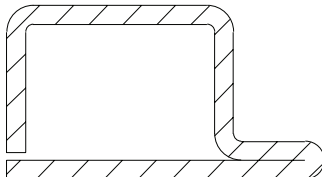

Large Transom / Mullion Z 82mm  
 White Profile Art. No. 546755  
 Laminated Profile Art. No. 576755

	261738	287776
	2.5mm	2mm
lx	6.06	5.14
ly	2.33	2.0

261738 - 42 x 23

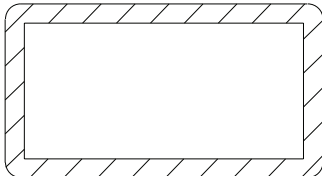

287776 - 42 x 23

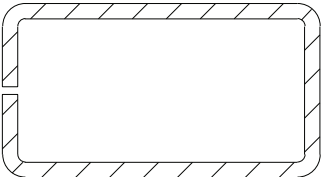

# REHAU TOTAL70s

## TRANSOM / MULLIONS

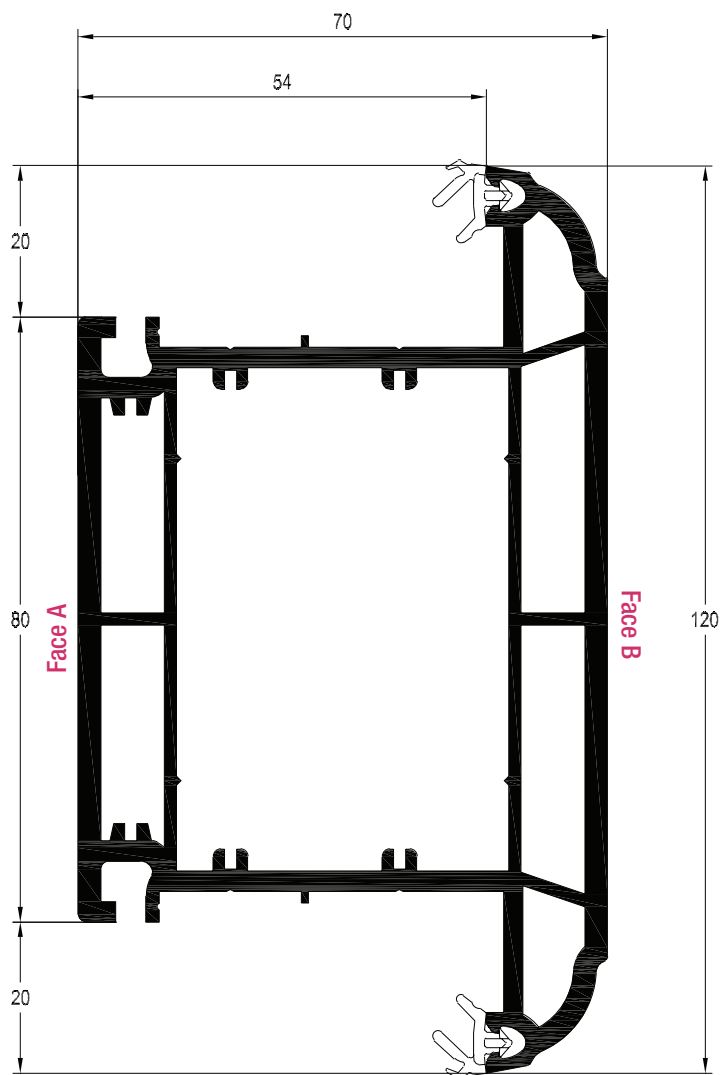

Extra Large Transom / Mullion T 120mm  
 White Profile Art. No. 546705  
 Laminated Profile Art. No. 576705

	287066
	2mm
lx	11.42
ly	15.89

287066 - 42 x 60

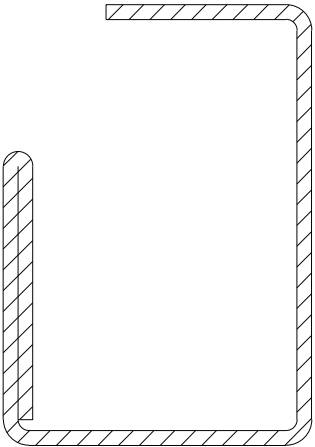

# REHAU TOTAL70s

## GLAZING BEADS

### FOR SINGLE GLAZING

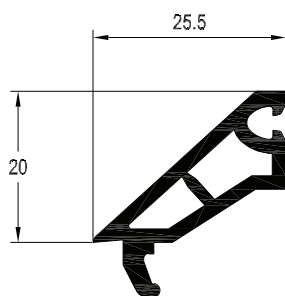

Non Co-extruded Glazing Bead 25.5mm  
White Art. No. 546110  
Laminated Art. No. 576290\*

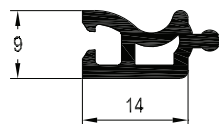

Adapter Bead  
White Art. No. 546310  
Condensation Adapter Bead 2

### FOR 20MM SEALED UNITS

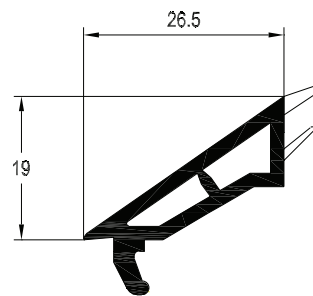

Co-extruded Glazing Bead 26.5mm  
White Art. No. 546150  
Laminated Art. No. 576330

### FOR 24MM SEALED UNITS

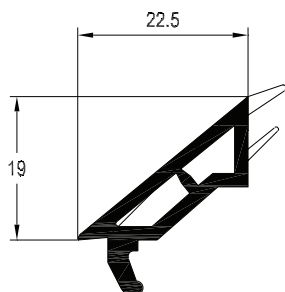

Co-extruded Glazing Bead 22.5mm  
White Art. No. 546140  
Laminated Art. No. 576320

### FOR 28MM SEALED UNITS

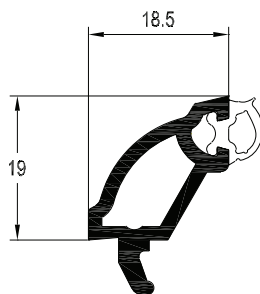

Co-extruded Glazing Bead 18.5mm  
White Art. No. 546572  
Laminated Art. No. 576572

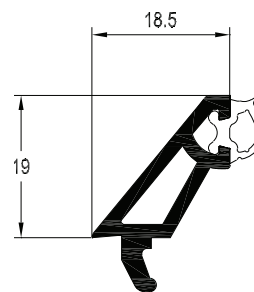

Co-extruded Glazing Bead 18.5mm  
White Art. No. 546132  
Laminated Art. No. 576132

### FOR 32MM SEALED UNITS

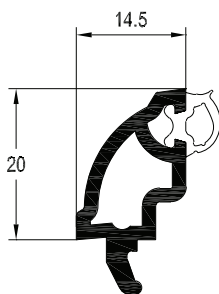

Co-extruded Glazing Bead 14.5mm  
White Art. No. 503681  
Laminated Art. No. 573679\*

### FOR 36MM SEALED UNITS

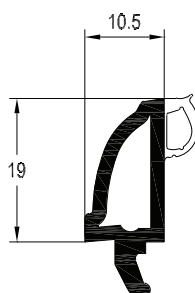

Co-extruded Glazing Bead 10.5mm  
White Art. No. 503720  
Laminated Art. No. 573720\*

### FOR 44MM SEALED UNITS

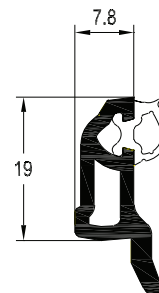



Co-extruded Glazing Bead 7.8mm  
White Art. No. 546860  
Laminated Art. No. 586865

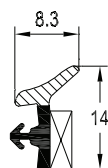

### FOR EXTERNAL GLAZING



Glazing Seal  
Art. No. 576130  
RAUSECUR  
Security Gasket - Black

Article Number	Variant Number	Description	Finish	Quantity (metres)	Packaging	Colour	
							
200327	001	Reinforcement 42 x 30 x 30 x 18 x 1.5mm	Steel	6	Length		*
200347	001	Reinforcement 42 x 30 x 23 x 2.5mm	Steel	6	Length		*
200374	001	Reinforcement 40 x 40 x 1.5mm	Steel	6	Length		*
249838	001	Reinforcement 42 x 10 x 1mm	Steel	6	Length		*
249848	001	Reinforcement 42 x 30 x 1mm	Steel	6	Length		*
252827	003	Reinforcement 40 x 40 x 40 x 12 x 2mm	Steel	6	Length		*
258841	003	Reinforcement 40 x 40 x 2mm (welded)	Steel	6	Length		*
261738	001	Reinforcement 42 x 23 x 2.5mm	Steel	6	Length		*
261748	001	Reinforcement 42 x 10 x 2mm	Steel	6	Length		*
261948	001	Reinforcement 42 x 10	Aluminium	6	Length		*
261958	001	Reinforcement 42 x 30 x 1.5mm	Steel	6	Length		*
261968*	001	Reinforcement 20 x 35 x 20 x 19 x 1.5mm	Steel	6	Length		*
262490	001	Reinforcement 40 x 40 x 40 x 12 x 2mm (pre-routed)	Steel	2.2	Length		*
287066	001	Reinforcement 42 x 60 x 2mm	Steel	6	Length		*
287776	001	Reinforcement 42 x 23 x 2mm	Steel	6	Length		*
287777	001	Reinforcement 20 x 35 x 20 x 19 x 1mm	Steel	6	Length		*
287779	001	Reinforcement 18 x 40 x 18 x 1mm	Steel	6	Length		*
287787	001	Reinforcement 40 x 40 x 40 x 12 x 1mm	Steel	6	Length		*
287789	001	Reinforcement 40 x 40 x 40 x 12 x 1mm (pre-routed)	Steel	2.2	Length		*
318555	001	Reinforcement 25 x 11 x 1mm	Steel	6	Length		*
318565	001	Reinforcement 25 x 21 x 1mm	Steel	6	Length		*
318575	001	Reinforcement 25 x 31 x 1mm	Steel	6	Length		*
318585	001	Reinforcement 28 x 23 x 1mm	Steel	6	Length		*
503681	701 / 705 / 715	Co-extruded Glazing Bead 14.5mm	White	144	Pack	*	
503720	701 / 705 / 715	Co-extruded Glazing Bead 10.5mm	White	144	Pack	*	
546110	701	Non Co-extruded Glazing Bead 25.5mm	White	144	Pack	*	
546132	701 / 705 / 715	Co-extruded Glazing Bead 18.5mm	White	144	Pack	*	
546140	701	Co-extruded Glazing Bead 22.5mm	White	144	Pack	*	
546150	701	Co-extruded Glazing Bead 26.5mm	White	144	Pack	*	
546310	701	Condensation Adapter Bead	White	288	Pack	*	
546415	701 / 901	Casement Slim Outer Frame 52mm (5 Chamber)	White	24 / 768	Pack/Stillage	*	
546425	701 / 901	Casement Intermediate Outer Frame 62mm (5 Chamber)	White	24 / 576	Pack/Stillage	*	
546435	701 / 901	Casement Universal Outer Frame 72mm (5 Chamber)	White	24 / 480	Pack/Stillage	*	
546455	701 / 901	Casement T Sash 75mm (5 Chamber)	White	24 / 576	Pack/Stillage	*	

Article Number	Variant Number	Description	Finish	Quantity (metres)	Packaging	Colour	
							
546572	701 / 705 / 715	Co-extruded Glazing Bead 18.5mm	White	144	Pack	*	
546586	701 / 901	Part Sculptured Casement T Sash 75mm	White	36 / 576	Pack / Stillage	*	
546655	701 / 901	Casement Universal Outer Frame 72mm	White	36 / 480	Pack / Stillage	*	
546665	701 / 901	Slim Transom / Mullion T 69mm	White	36 / 648	Pack / Stillage	*	
546675	701 / 901	Slim Transom / Mullion Z 69mm	White	36 / 624	Pack / Stillage	*	
546685	701 / 901	Casement T Sash 75mm	White	36 / 576	Pack / Stillage	*	
546695	701 / 901	Tilt and Turn Sash 70mm	White	36 / 624	Pack / Stillage	*	
546715	701 / 901	Door Z Sash 105.5mm	White	24 / 336	Pack / Stillage	*	
546725	701 / 901	Door T Sash / Midrail 105.5mm	White	24 / 336	Pack / Stillage	*	
546745	701	Large Transom / Mullion T 82mm	White	39	Pack	*	
546755	701	Large Transom / Mullion Z 82mm	White	26	Pack	*	
546860	701 / 705 / 715	Co-extruded Glazing Bead 7.8mm	White	144	Pack	*	
576130	002	Security Gasket	Black	400	Spool		*
576132	790	Co-extruded Glazing Bead 18.5mm	Golden Oak	72	Pack		*
576132	251	Co-extruded Glazing Bead 18.5mm	Rosewood	72	Pack		*
576267	251 / 221 / 261	Part Sculptured Casement T Sash 75mm	Golden Oak	36	Pack		*
576267	351 / 321 / 361	Part Sculptured Casement T Sash 75mm	Rosewood	36	Pack		*
576320	251	Co-extruded Glazing Bead 22.5mm	Rosewood	144	Pack		*
576320	351	Co-extruded Glazing Bead 22.5mm	Golden Oak	144	Pack		*
576330	251	Co-extruded Glazing Bead 26.5mm	Rosewood	72	Pack		*
576572	251 / 270	Co-extruded Glazing Bead 18.5mm	Rosewood	144	Pack		*
576572	790 / 351	Co-extruded Glazing Bead 18.5mm	Golden Oak	144	Pack		*
576665	251 / 221 / 261	Slim Transom / Mullion T 69mm	Rosewood	36	Pack		*
576665	351 / 321 / 361	Slim Transom / Mullion T 69mm	Golden Oak	36	Pack		*
576675	251 / 221	Slim Transom / Mullion Z 69mm	Rosewood	36	Pack		*
576675	351 / 321	Slim Transom / Mullion Z 69mm	Golden Oak	36	Pack		*
576685	251 / 221 / 261	Casement T Sash 75mm	Rosewood	36	Pack		*
576685	351 / 321 / 361	Casement T Sash 75mm	Golden Oak	36	Pack		*
576695	251 / 221	Tilt and Turn Sash 70mm	Rosewood	36	Pack		*
576695	351 / 321	Tilt and Turn Sash 70mm	Golden Oak	36	Pack		*
576715	251 / 221	Door Z Sash 105.5mm	Rosewood	24	Pack		*
576715	351 / 321	Door Z Sash 105.5mm	Golden Oak	24	Pack		*
576725	251 / 221 / 261	Door T Sash / Midrail 105.5mm	Rosewood	24/24/12	Pack		*
576725	351 / 321 / 361	Door T Sash / Midrail 105.5mm	Golden Oak	24	Pack		*

Article Number	Variant Number	Description	Finish	Quantity (metres)	Packaging	Colour	
						 White	 Other
576745	251 / 221 / 261	Large Transom / Mullion T 82mm	Rosewood	39	Pack		*
576745	351 / 321 / 361	Large Transom / Mullion T 82mm	Golden Oak	39	Pack		*
576755	251 / 221	Large Transom / Mullion Z 82mm	Rosewood	26	Pack		*
576755	351 / 321	Large Transom / Mullion Z 82mm	Golden Oak	26	Pack		*
586415	251 / 221 / 261	Casement Slim Outer Frame 52mm (5 Chamber)	Rosewood	12	Pack		*
586415	351 / 321 / 361	Casement Slim Outer Frame 52mm (5 Chamber)	Golden Oak	12	Pack		*
586425	251 / 221 / 261	Casement Intermediate Outer Frame 62mm (5 Chamber)	Rosewood	12	Pack		*
586425	351 / 321 / 361	Casement Intermediate Outer Frame 62mm (5 Chamber)	Golden Oak	12	Pack		*
586435	251 / 221 / 261	Casement Universal Outer Frame 72mm (5 Chamber)	Rosewood	12	Pack		*
586435	351 / 321 / 361	Casement Universal Outer Frame 72mm (5 Chamber)	Golden Oak	12	Pack		*
586455	251 / 221 / 261	Casement T Sash 75mm (5 Chamber)	Rosewood	12	Pack		*
586455	351 / 321 / 361	Casement T Sash 75mm (5 Chamber)	Golden Oak	12	Pack		*
586865	251	Co-extruded Glazing Bead 7.8mm	Rosewood	144	Pack		*
586865	790	Co-extruded Glazing Bead 7.8mm	Golden Oak	144	Pack		*

NOTES

---

## REHAU TOTAL70s Sculptured Profile Print



SCULPTURED  
SYSTEM

### UK & IRELAND SALES OFFICES

**London**, REHAU Ltd, The Building Centre, 25 Store Street, London WC1E 7BT Phone: 0207 580 6155 Fax: 0207 307 8595 **Slough**, Units 5 J & K, Langley Business Centre, Station Road, Langley, Slough SL3 8DS Phone: 01753 588500 Fax: 01753 588501 **Manchester**, Brinell Drive, Irlam, Manchester M44 5BL Phone: 0161 777 7400 Fax: 0161 777 7401 **Glasgow**, Phoenix House, Phoenix Crescent, Strathclyde Business Park, Bellshill, North Lanarkshire ML4 3NJ Phone: 01698 503700 Fax: 01698 503701 **Dublin**, 9 St. Johns Court, Business Park, Swords Road, Santry, Dublin 9 Phone: 00353 (0)1 8165020 Fax: 00353 (0)1 8165021

Our verbal and written application engineering advice is based upon experience and the best of our knowledge. However, it is to be regarded as non-binding information. Working conditions and use under conditions for which the product was not intended and over which we have no influence exclude any claim resulting from our information. We recommend that a check is made as to whether the REHAU product is suitable for the envisaged purpose. Application, use and processing of the products is carried out beyond the scope of our control and are therefore carried out exclusively at your own responsibility. If liability should still apply, then this is restricted, in the case of all damage, the value of the goods supplied by us and used by you.

Our warranty applies to the consistent quality of our products as per our specification and in accordance with our general terms and conditions of delivery and payment. This document is protected by copyright. All rights based on this are reserved. No part of this publication may be translated, reproduced or transmitted in any form or by any similar means, electronic or mechanical, photocopying, recording or otherwise, or stored in a data retrieval system.